

► Handle

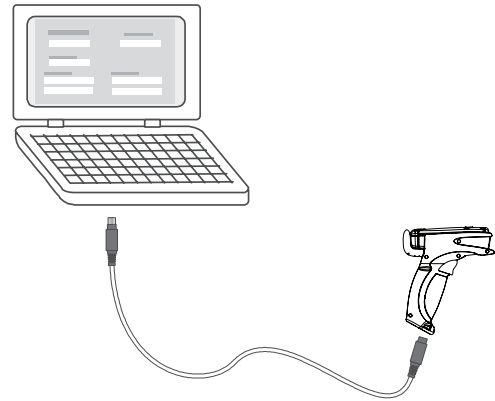

► USB Interface Cable



► LightRay 100 Series

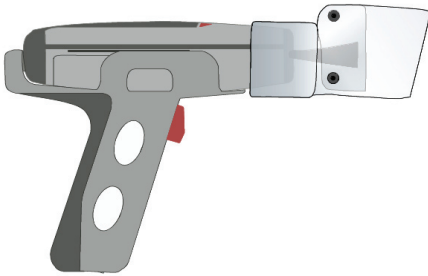

► LightRay 200 Series

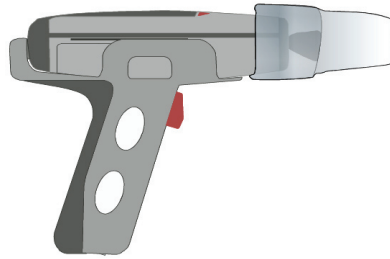

► RS-232 Cable

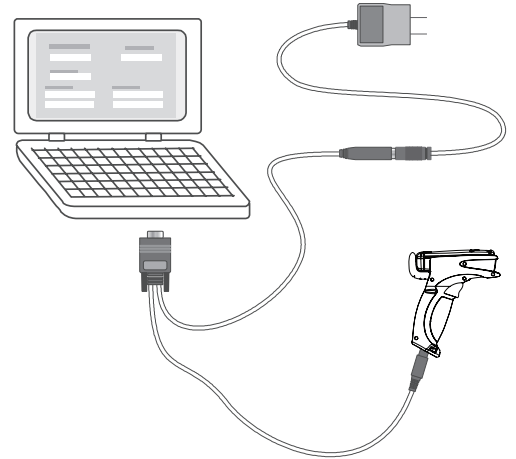

Patents: U.S. 6,352,204 and 6,854,650

► Battery Charger



► Lithium Ion Battery

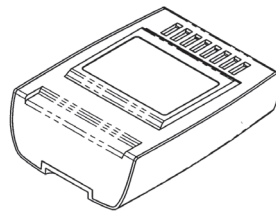

► Battery Blank

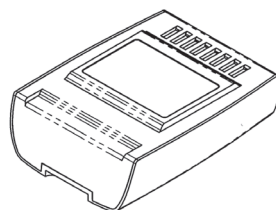

► Bluetooth™ (Wireless) Modem

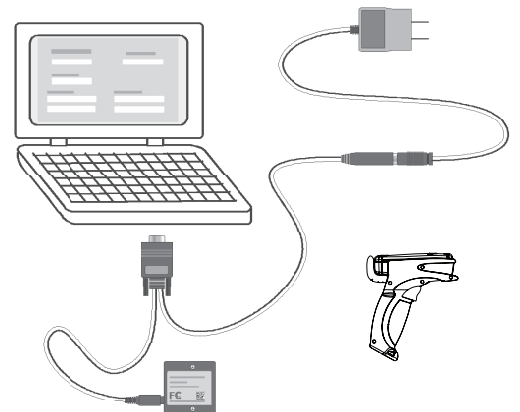

# MS-Q IMAGER ACCESSORIES

## COMMUNICATION OPTIONS

Accessory	Microscan Part Number	Description
USB Cable	60-000009-02	USB communication cable, 6' (1.8 m).
Bluetooth Modem Kit (Serial Gateway)	98-000076-07 (U.S) 98-000076-08 (Euro) 98-000076-09 (U.K) 98-000076-10 (USB)	Bluetooth to serial gateway with power supply integrated into the unit. Allows for wireless communication.
RS232 Kit	98-000074-01 (U.S) 98-000074-02 (Euro) 98-000074-03 (U.K)	Kit, RS232 interface, 8' (2.4 m) coiled cable.
MS-Connect 210	FIS-0210-0004-G	Connectivity Box with Ethernet

## OPTICAL ACCESSORIES

LightRay 100 Series	Call Microscan	The LightRay 100 Series is a patented optical accessory designed for the MS-Q. The optical attachment directs and diffuses the illumination to optimize the MS-Q to read direct part mark (DPM) symbols on curved or highly reflective surfaces.
LightRay 200 Series	Call Microscan	The LightRay 200 Series is a patented optical accessory designed for the MS-Q. The optical attachment allows light to be directed at an increased shallow angle which increases symbol contrast on direct part mark symbols.

## POWER, BATTERY & HANDLES

Handle Options	12-000215-06 12-000215-07 12-000215-08 20-000338-02	Rugged Handle for use with MS-Q, with battery blank (H2). Rugged Handle for use with MS-Q, with 1950 mAh Battery (BH1). Rugged Handle for use with MS-Q, with 3900 mAh Battery (BH2)). Battery Blank (H1 Handle)
Power Supply	20-000335-02 (U.S) 20-000336-02 (Euro) 20-000337-02 (U.K)	Offered in US, European, and UK formats. Provided in Bluetooth Modem, Battery Charger, and RS232 kits. Wall mounted, 90-264 VAC, +5 VDC 1.5A (2.4A, U.K. version). Cable length: 8.7' (2.7 m).
Battery Charger	98-000075-10 (U.S) 98-000075-12 (U.K) 98-000075-13 (No power supply)	Charging bays for BH1 and BH2.

## DOCUMENTATION

ESP™ Software, User Manuals	37-000001-01	User Manuals CD and ESP® software (1 copy free per order).
-----------------------------	--------------	--

\*Included in the MS-Q Imager purchase. Parts can be purchased as spares.

©2008 Microscan Systems. Specifications subject to change. REV B

[www.quadrusmini.com](http://www.quadrusmini.com)

**MICROSCAN**

1201 S.W. 7th Street | Renton, WA 98057 | 425.226.5700 | [www.microscan.com](http://www.microscan.com) | [info@microscan.com](mailto:info@microscan.com)



ISO 9001:2000  
Certified QMS